

## ALR-1920-120

### Multi Purpose LCD Controller Board

#### Key Features :

- > Supports 120Hz panels up to 1920x1200 resolution
- > HDMI and DisplayPort input signals
- > Advanced image processing
- > Designed for commercial display systems

The ALR-1920-120 is a compact and easy to work with controller solution for 120Hz panels up to 1920x1200 resolution. A comprehensive range of features and control options make this ideal for a wide range of commercial display systems.

#### Panel Connectivity

**TFT:** 1920x1200 (120Hz or 60Hz)  
1920x1080 (120Hz or 60Hz)  
1280x1024 (60Hz)

#### Input

**HDMI 1.3:** 60Hz at WUXGA, UXGA, SXGA, WXGA, XGA, SVGA, VGA, 1080p, 1080i, 720p, 576p, 480p

**DisplayPort 1.1a:** 60Hz at WUXGA, UXGA, SXGA, WXGA, XGA, SVGA, VGA 1080p, 1080i, 720p, 576p, 480p

#### Reliability

Calculated Mean Time Between Failure (MTBF): In excess of 200,000 hours.  
Warranty: 3 years.

#### Custom Engineering Services

Custom input timing, panel timing, splash screen, OSD Menu, conformal coatings, layouts etc

#### Features

<b>Colors:</b>	Up to 8 bit per color, ie 16.7 million colors.
<b>Functions:</b>	On Screen Display (OSD) menu
<b>Function Controls:</b>	External buttons, IR Remote, RS-232, DDC/CI.
<b>Image Scaling:</b>	Up / Down* scaling to fit input to panel resolution.
<b>Image Control:</b>	Brightness, Contrast, Sharpness, Color temperature, Gamma.
<b>Other Features:</b>	Auto source seek, OSD timeout, OSD position, OSD menu rotation, OSD transparency, select input source.
<b>Dimensions:</b>	127mm x 91.44mm x 17.3mm
<b>Form Factor:</b>	DV standard & mounting holes.
<b>Power Requirements:</b>	+12V/+24VDC ±5%, 4W (controller only)
<b>Panel Power:</b>	Supports 3.3V, 5V, 12V & 18V panels.
<b>Panel Signal:</b>	LVDS (VESA & JEIDA compliant).
<b>Inverter Support:</b>	DPMS, PWM
<b>Plug &amp; Play:</b>	DDC 1,2/b compatible
<b>Controller Status Indicator:</b>	Dual color LED support

\* To 50% of the input signal resolution compared to the panel resolution

## ALR-1920-120

### Multi Purpose LCD Controller Board

#### Mechanical Drawing

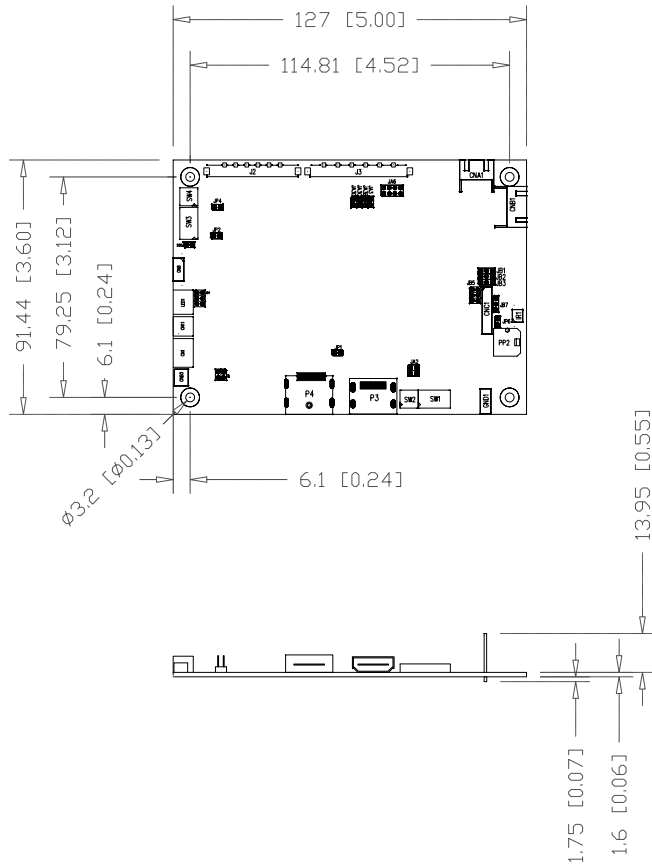

#### Connector Definitions

<b>CN1</b>	Audio output (Stereo) with amplification from HDMI / Display port
<b>CN8</b>	RS-232 serial control
<b>CN11</b>	SPDIF Audio output
<b>CNA1</b>	Auxiliary power output
<b>CNB1</b>	Backlight inverter
<b>CNB3</b>	Panel backlight control
<b>CNC1</b>	OSD controls
<b>IR1</b>	Infra-Red sensor connector
<b>LED1</b>	Controller status LED (Optional)
<b>J2</b>	LVDS panel signal output 1
<b>J3</b>	LVDS panel signal output 2
<b>P3</b>	HDMI input
<b>P4</b>	Display port input
<b>PP2</b>	Power input

#### Ordering Options

<b>ALR-1920-120 Controller Board</b>	<b>P/N 41731003X-3</b>
Digital OSD button	Kit 67110-3
Horizontal membrane	Kit 67134-3
Vertical membrane	Kit 67135-3
Inverter Interface board	P/N 416040010-3
OSD switch mount cable, 150mm	P/N 426122200-3
IR Remote Control	P/N 559000106-3

#### 3D Drawings (SLDPRT)

Save time and effort for your system volumetric analysis design. Includes jpg file previews.

#### Available Resources

- > Instruction Manual
  - > Revision Control Documentation\*\*
  - > Firmware Upgrade Manual\*\*
  - > Mechanical Drawing
- \*\* Available on Request

**Controller Solution Generator**  
<http://www.digitalview.com/csg>

DIGITAL VIEW®

[www.digitalview.com](http://www.digitalview.com)